

# The Hand Cuff Fracture Orthosis

**Warnings and Instructions: Review carefully, proper application is required** 1010

**⚠ Warning:** This device will not prevent or eliminate risk of injury. Do Not Overtighten. If swelling, pain, skin irritation, or an unusual reaction occurs, discontinue use immediately and consult your medical professional.

This device should not be worn by persons with known allergies to neoprene.

Care: Hand wash using mild soap. Rinse thoroughly. Air dry only. Do not tumble dry.

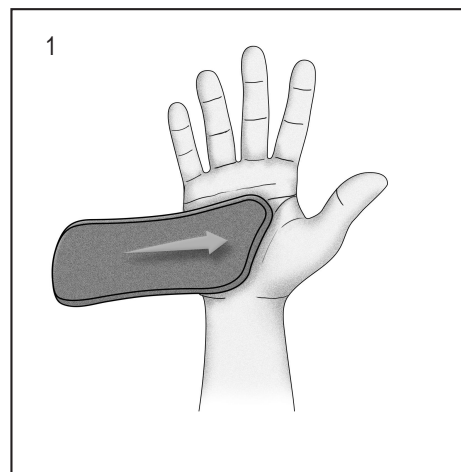

1. Align the edge of the brace with the thenar crease and distal palmar crease as shown.

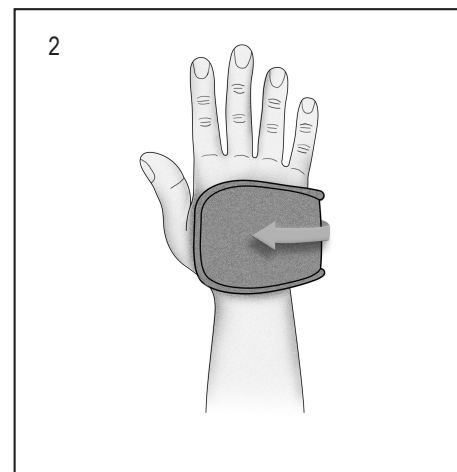

2. Mold the brace around the hand to form a custom fit.

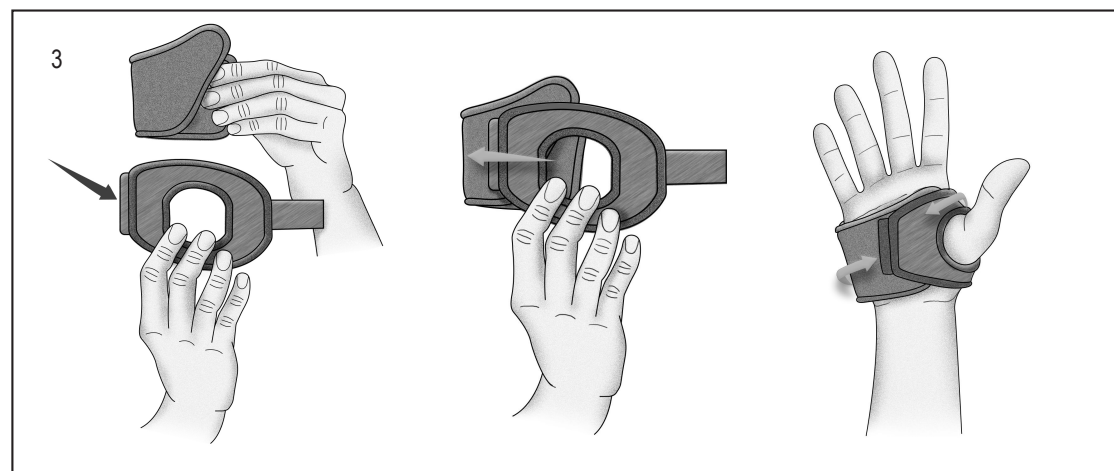

3. Attach the closure strap as shown to the front of the brace. Insert thumb in hole.

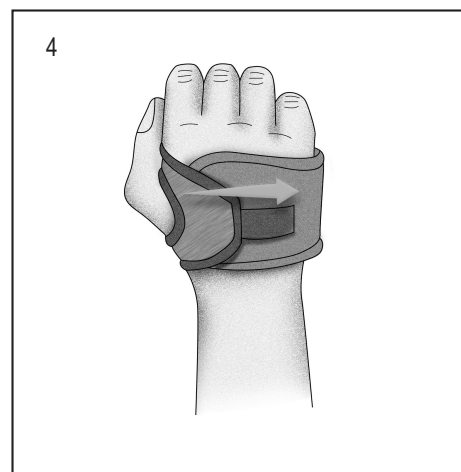

4. Affix closure strap. Closure will be on the back of the hand. Continue to mold the brace for improved fit. Application is complete.

# The Hand Cuff Fracture Orthosis

**Warnings and Instructions: Review carefully, proper application is required** 1010

**⚠ Warning:** This device will not prevent or eliminate risk of injury. Do Not Overtighten. If swelling, pain, skin irritation, or an unusual reaction occurs, discontinue use immediately and consult your medical professional.

This device should not be worn by persons with known allergies to neoprene.

Care: Hand wash using mild soap. Rinse thoroughly. Air dry only. Do not tumble dry.

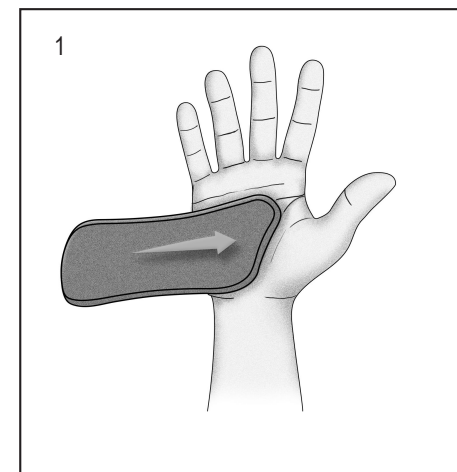

1. Align the edge of the brace with the thenar crease and distal palmar crease as shown.

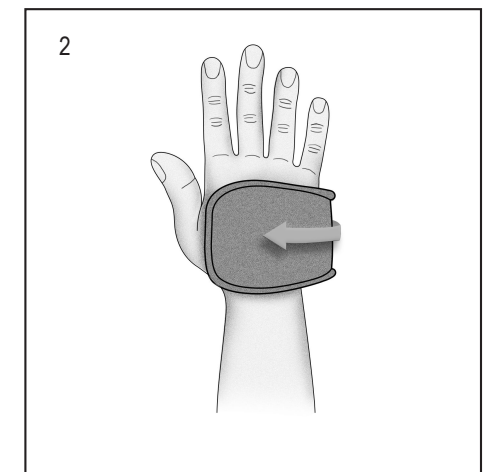

2. Mold the brace around the hand to form a custom fit.

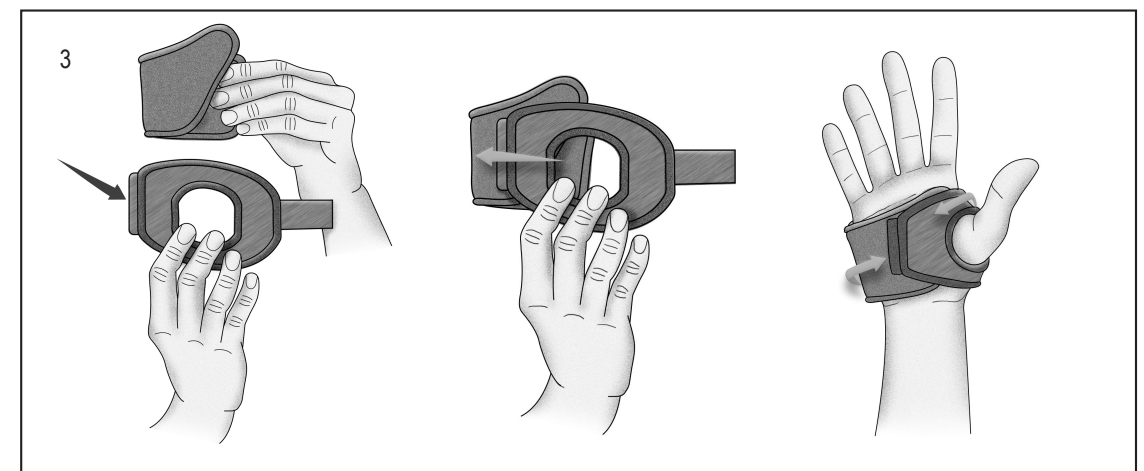

3. Attach the closure strap as shown to the front of the brace. Insert thumb in hole.

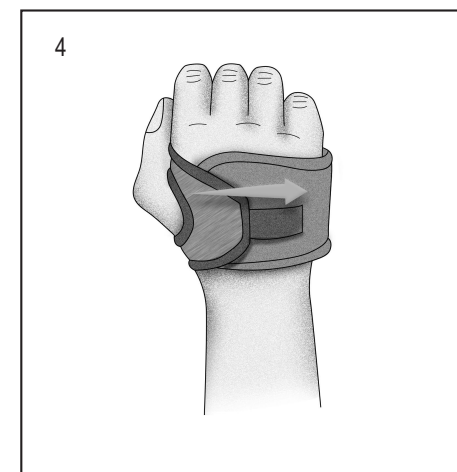

4. Affix closure strap. Closure will be on the back of the hand. Continue to mold the brace for improved fit. Application is complete.